



MANUAL DE INSTALACIÓN

Club 322F

Club 3412T

Club 422F

Club 522F

Club 602C

Club 602CTP

Club 620F

Club 622

Club 6422F

Club 8622F

Club 9632

Club 322F

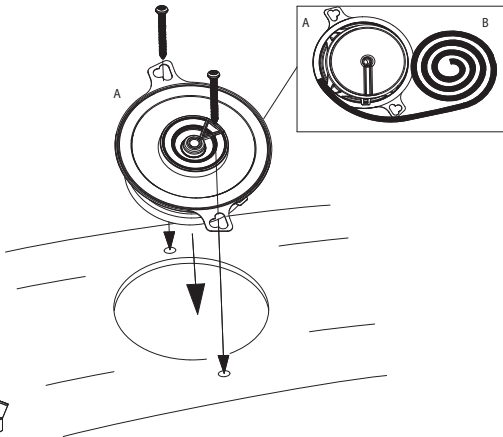
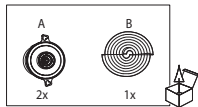
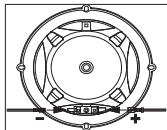

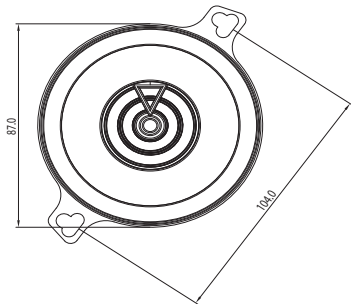
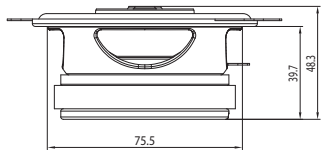

Especificaciones

- Tipo: Altavoz de 2 vías y 3-1/2" (87 mm) para automóvil
- Capacidad de potencia: 25 vatios RMS, 75 vatios (máx.)
- Sensibilidad (2,83 V/m): 89 dB
- Respuesta de frecuencia: 90 Hz – 20 kHz
- Impedancia nominal: 3,0 ohmios

Parámetros de Thiele-Small

- BL (Tm): 2,873
- DCR (ohms): 2,26
- Mms (g): 3,723
- Sd (cm²): 44,18
- Cms (μm/N): 0,491
- Vas (l): 1,3574
- Fs (Hz): 117,7
- Qes: 0,755
- Qms: 7,777
- Qts: 0,688
- Crossover Point: 4kHz

Club 3412T

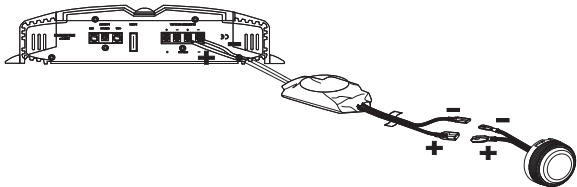
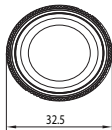
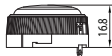

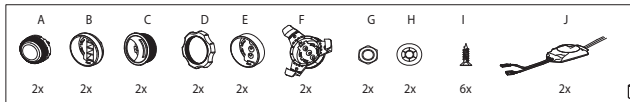
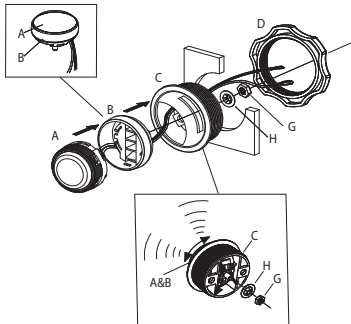
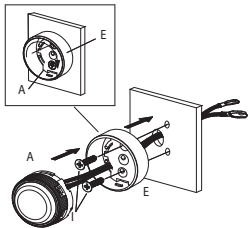

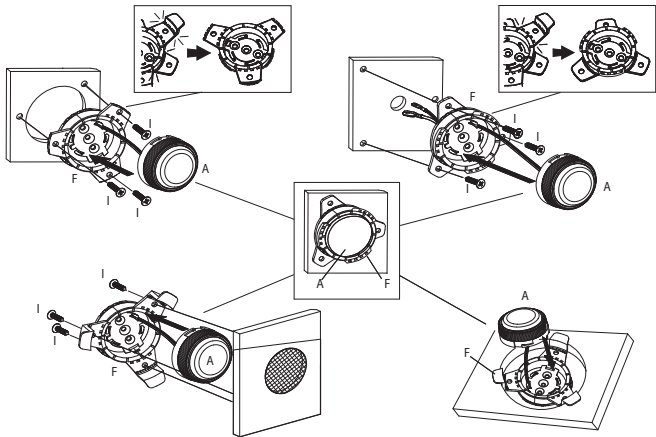

Especificaciones

- Tipo: Altavoz de agudos con cúpula de dispersión de 3/4" (19 mm)
- Capacidad de potencia: 50 vatios RMS, 150 vatios (máx.)
- Sensibilidad (2,83 V): 92 dB
- Respuesta de frecuencia:
3k Hz – 20 kHz
- Impedancia nominal: 3,0 ohmios

Club 422F

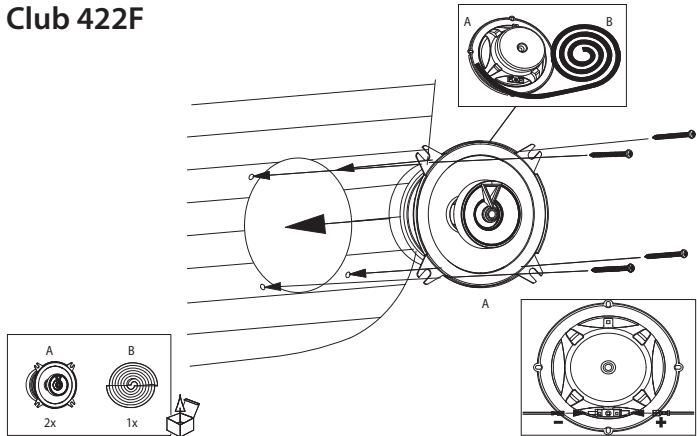

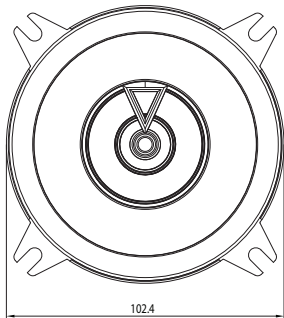
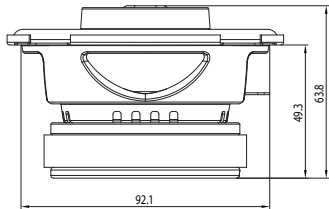

Especificaciones

- Tipo: Altavoz de 2 vías y 4" (100 mm) para automóvil
- Capacidad de potencia: 35 vatios RMS, 105 vatios (máx.)
- Sensibilidad (2,83 V): 90 dB
- Respuesta de frecuencia: 75 Hz – 20 kHz
- Impedancia nominal: 3,0 ohmios

Parámetros de Thiele-Small

- BL (Tm): 3,783
- DCR (ohms): 2,46
- Mms (g): 6,608
- Sd (cm²): 63,62
- Cms (μm/N): 0,750
- Vas (l): 4,2937
- Fs (Hz): 71,5
- Qes: 0,510
- Qms: 6,495
- Qts: 0,473
- Crossover Point: 3kHz

Club 522F

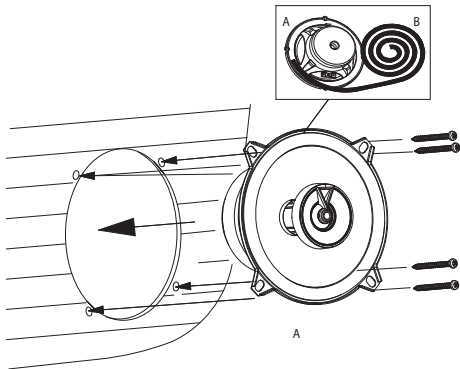
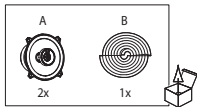
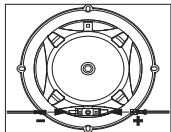

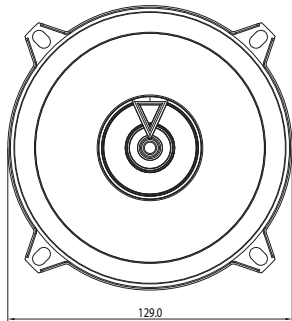
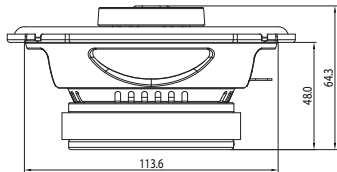

Especificaciones

- Tipo: Altavoz de 2 vías y 5-1/4" (130 mm) para automóvil
- Capacidad de potencia: 45 vatios RMS, 135 vatios (máx.)
- Sensibilidad (2,83 V): 91 dB
- Respuesta de frecuencia: 75 Hz – 20 kHz
- Impedancia nominal: 3,0 ohmios

Parámetros de Thiele-Small

- BL (Tm): 3,563
- DCR (ohms): 2,24
- Mms (g): 9,484
- Sd (cm²): 103,87
- Cms (μm/N): 0,274
- Vas (l): 4,1850
- Fs (Hz): 98,7
- Qes: 1,036
- Qms: 8,608
- Qts: 0,925
- Crossover Point: 3kHz

Club 602C

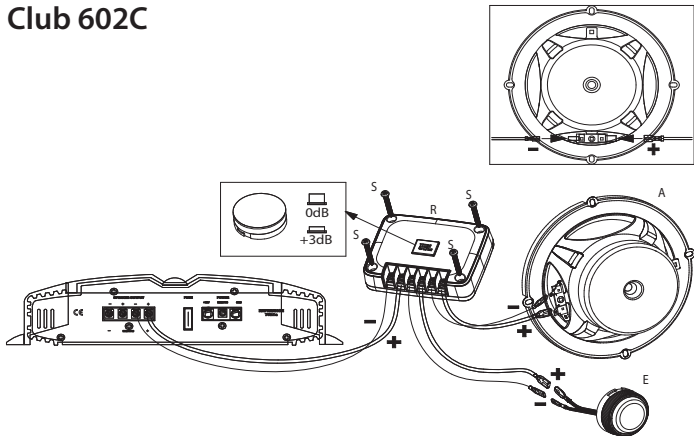

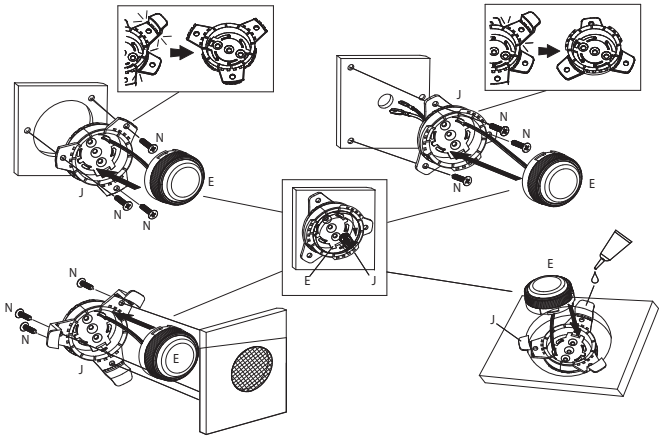

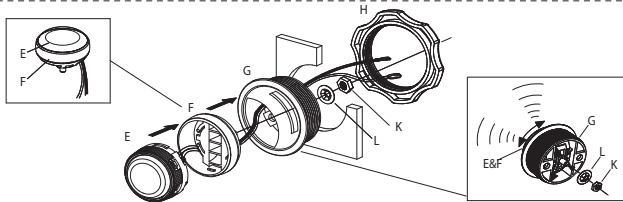
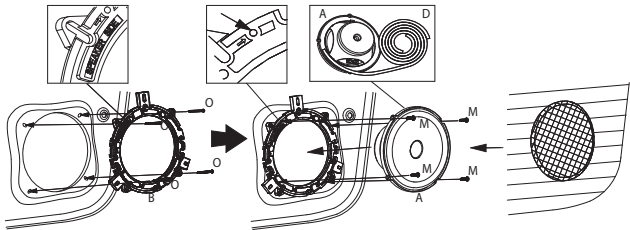

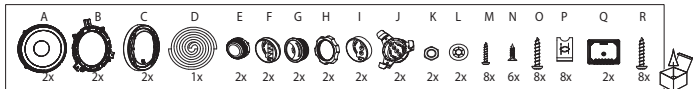
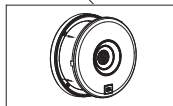
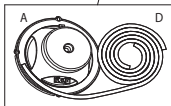
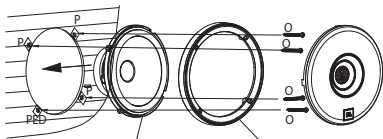
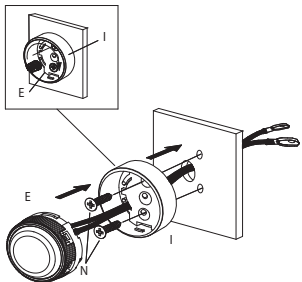

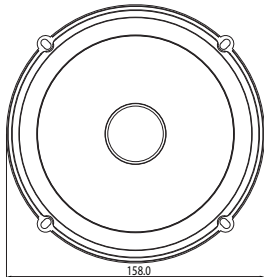
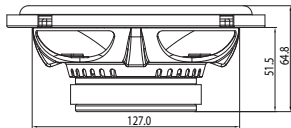
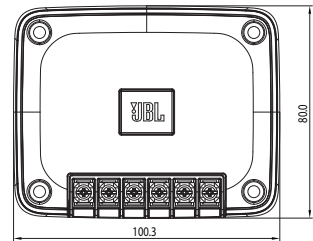

Especificaciones

- Tipo: Sistema de altavoz con componentes de 2 vías y 6-1/2" (160 mm)
- Capacidad de potencia: 70 vatios RMS, 210 vatios (máx.)
- Sensibilidad (2,83 V): 92 dB
- Respuesta de frecuencia: 55 Hz – 20 kHz
- Impedancia nominal: 3,0 ohmios

Parámetros de Thiele-Small

- BL (Tm): 3,635
- DCR (ohms): 2,37
- Mms (g): 14,409
- Sd (cm²): 132,73
- Cms (μm/N): 0,257
- Vas (l): 6,4107
- Fs (Hz): 82,7
- Qes: 1,340
- Qms: 10,965
- Qts: 1,194
- Crossover Point: 5,5kHz

Club 602CTP

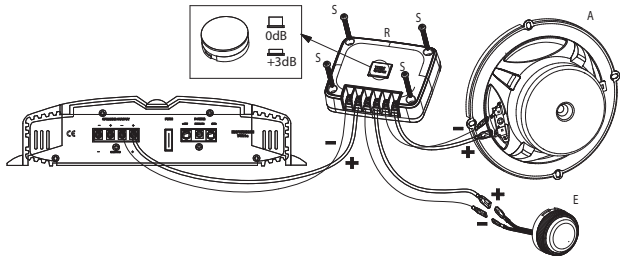
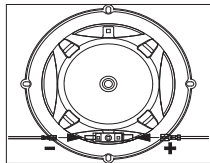

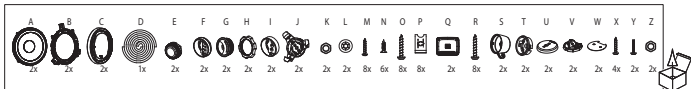
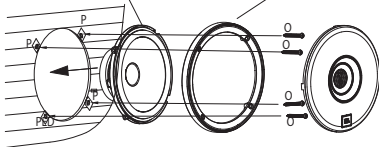
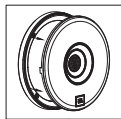
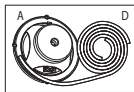
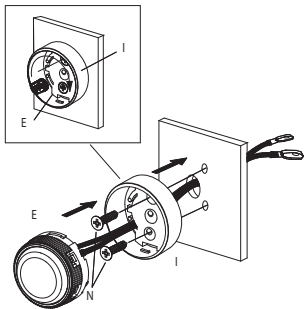

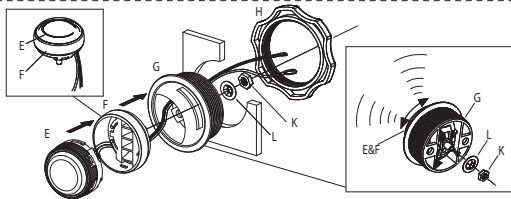
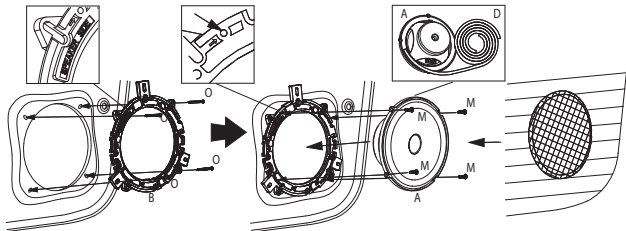

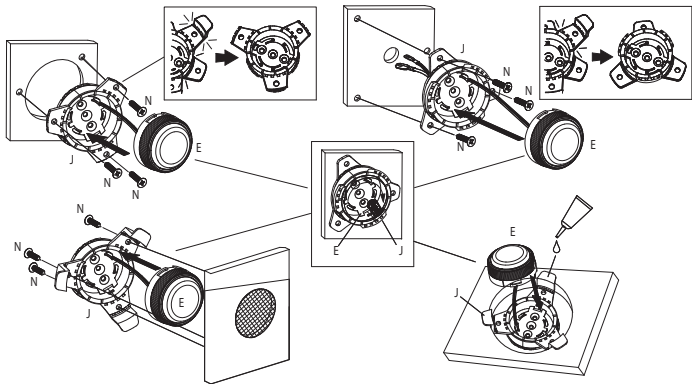

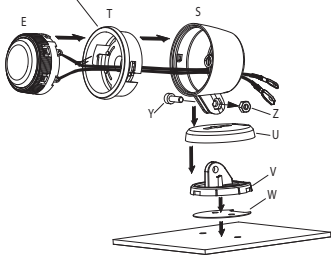
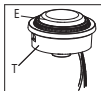
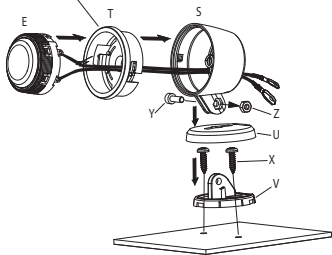
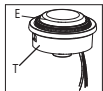

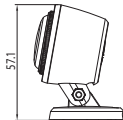
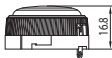
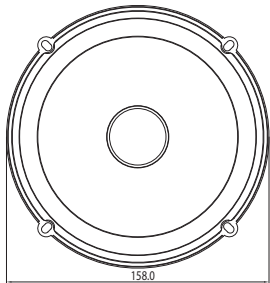
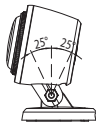
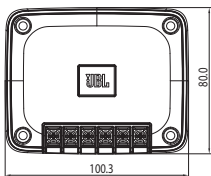
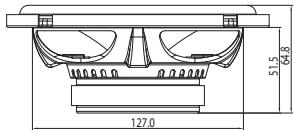

Especificaciones

- Tipo: Sistema de altavoces de componentes de dos vías de 6-1/2" (160 mm) con pod de altavoz de agudos
- Capacidad de potencia: 70 vatios RMS, 210 vatios (máx.)
- Sensibilidad (2,83 V): 92 dB
- Respuesta de frecuencia: 55 Hz – 20 kHz
- Impedancia nominal: 3,0 ohmios

Parámetros de Thiele-Small

- BL (Tm): 3,635
- DCR (ohms): 2,37
- Mms (g): 14,409
- Sd (cm²): 132,73
- Cms (μm/N): 0,257
- Vas (l): 6,4107
- Fs (Hz): 82,7
- Qes: 1,340
- Qms: 10,965
- Qts: 1,194
- Crossover Point: 5,5kHz

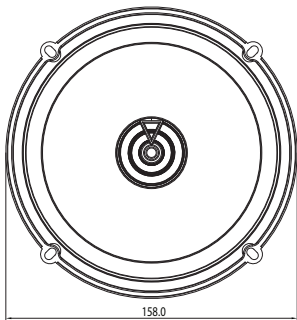
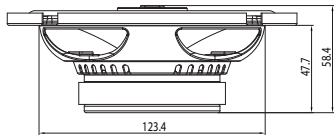

Especificaciones

- Tipo: Altavoz de montura plana con 2 vías y 6-1/2" (160 mm) para automóvil
- Capacidad de potencia: 55 vatios RMS, 165 vatios (máx.)
- Sensibilidad (2,83 V): 92 dB
- Respuesta de frecuencia: 55 Hz – 20 kHz
- Impedancia nominal: 3,0 ohmios

Parámetros de Thiele-Small

- BL (Tm): 3,739
- DCR (ohms): 2,41
- Mms (g): 9,934
- Sd (cm²): 122,72
- Cms (μm/N): 0,278
- Vas (l): 5,9287
- Fs (Hz): 95,7
- Qes: 1,032
- Qms: 11,357
- Qts: 0,946
- Crossover Point: 4kHz

Club 622

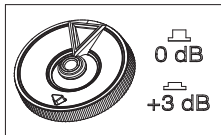
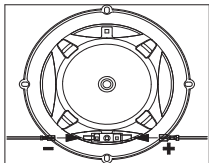

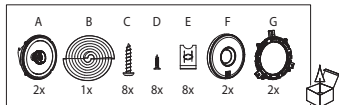
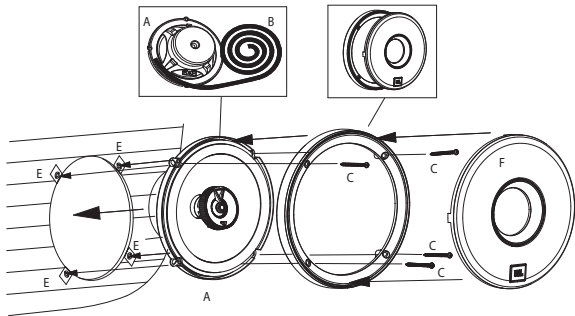

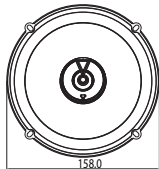
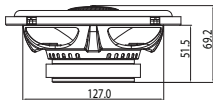
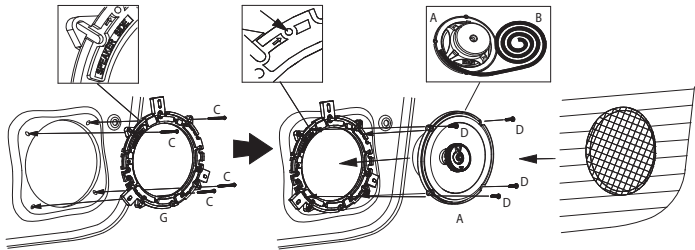

Especificaciones

- Tipo: Altavoz de 2 vías y 6-1/2" (160 mm) para automóvil, diseñado con prestaciones para un sonido mejor.
- Capacidad de potencia: 60 vatios RMS, 180 vatios (máx.)
- Sensibilidad (2,83 V): 93 dB
- Respuesta de frecuencia: 48 Hz – 21 kHz
- Impedancia nominal: 3,0 ohmios

Parámetros de Thiele-Small

- BL (Tm): 3,632
- DCR (ohms): 2,36
- Mms (g): 13,758
- Sd (cm²): 132,73
- Cms (μm/N): 0,378
- Vas (l): 9,4253
- Fs (Hz): 69,8
- Qes: 1,080
- Qms: 10,655
- Qts: 0,980
- Crossover Point: 3,5kHz

Club 6422F

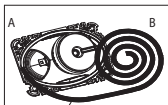
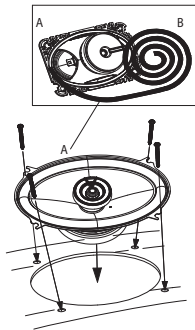
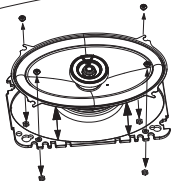
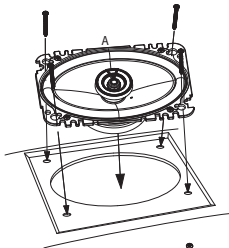
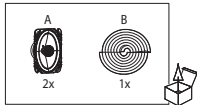
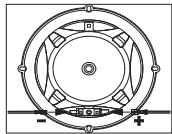

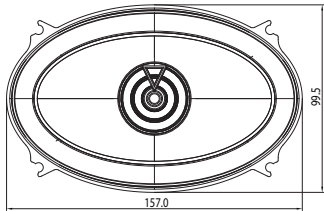
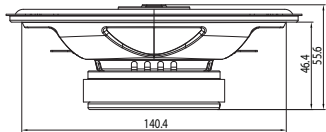

Especificaciones

- Tipo: Altavoz de 2 vías y 4 x 6" (100 x 152 mm) para automóvil
- Capacidad de potencia: 40 vatios RMS, 120 vatios (máx.)
- Sensibilidad (2,83 V): 92 dB
- Respuesta de frecuencia: 75 Hz – 20 kHz
- Impedancia nominal: 3,0 ohmios

Parámetros de Thiele-Small

- BL (Tm): 3,296
- DCR (ohms): 2,5
- Mms (g): 7,86
- Sd (cm²): 86,59
- Cms (μm/N): 0,245
- Vas (l): 2,5977
- Fs (Hz): 114,7
- Qes: 1,303
- Qms: 12,752
- Qts: 1,182
- Crossover Point: 3kHz

Club 8622F

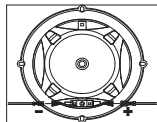
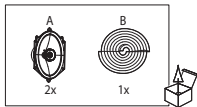
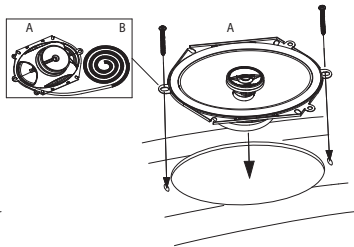
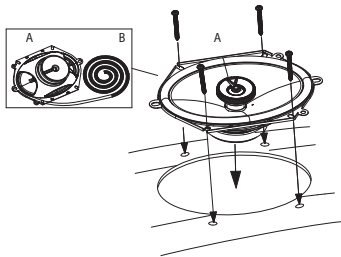

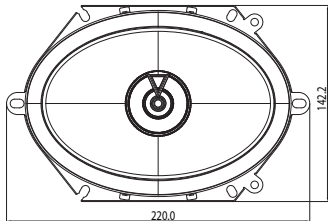
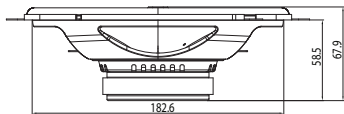

Especificaciones

- Tipo: Altavoz de 2 vías y 6x8" (152 x 203 mm) para altavoz, sin rejilla
- Capacidad de potencia: 60 vatios RMS, 180 vatios (máx.)
- Sensibilidad (2,83 V): 93 dB
- Respuesta de frecuencia: 65 Hz – 20 kHz
- Impedancia nominal: 3,0 ohmios

Parámetros de Thiele-Small

- BL (Tm): 3,785
- DCR (ohms): 2,39
- Mms (g): 17,718
- Sd (cm²): 165,13
- Cms (μm/N): 0,336
- Vas (l): 12,9798
- Fs (Hz): 65,2
- Qes: 1,210
- Qms: 14,592
- Qts: 1,118
- Crossover Point: 3,5kHz

Club 9632

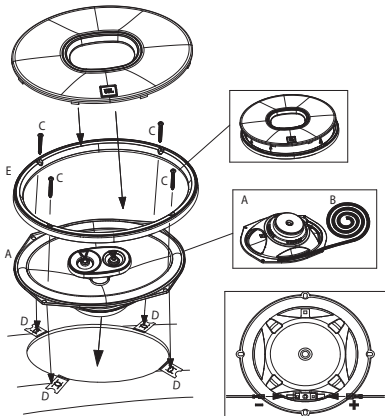
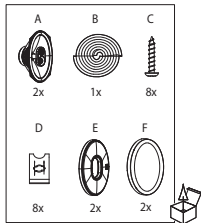

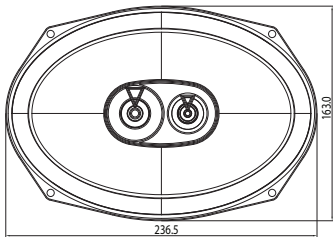
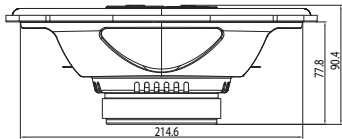

Especificaciones

- Tipo: Altavoz de 3 vías y 6 x 9" (152 x 230 mm) para automóvil
- Capacidad de potencia: 85 vatios RMS, 255 vatios (máx.)
- Sensibilidad (2,83 V): 93 dB
- Respuesta de frecuencia: 50 Hz – 20 kHz
- Impedancia nominal: 3,0 ohmios

Parámetros de Thiele-Small

- BL (Tm): 4,063
- DCR (ohms): 2,63
- Mms (g): 23,163
- Sd (cm²): 226,98
- Cms (μm/N): 0,337
- Vas (l): 24,5866
- Fs (Hz): 56,9
- Qes: 1,321
- Qms: 11,751
- Qts: 1,188
- Crossover Point: 3kHz



HARMAN International
Industries, Incorporated
8500 Balboa Boulevard,
Northridge, CA 91329, EE. UU.

© 2019 HARMAN International
Industries, Incorporated.

Todos los derechos reservados.

JBL es marca comercial de HARMAN International Industries, Incorporated, registrada en los Estados Unidos y/o en otros países.

Las funciones, especificaciones y aspecto del producto están sujetos a cambio sin previo aviso.